

NEW SITE DEVELOPMENT

DEVELOPMENT WILL BE COMPLETED FROM JUNE 2022

LUXURY
HOLIDAY HOMES

AVAILABLE

for Pre Order



Newbridge

Country Park

Glamping • Camping • Caravans • Lodges

Enquire Today

info@newbridgecountrypark.co.uk

NEWBRIDGE COUNTRY PARK, GLASGOW ROAD , DUMFRIES, DG2 0LF

Pre Order Today

**GET YOUR FIRST YEAR OF SITE FEE'S
FOR FREE**

Newbridge

Country Park

Glamping • Camping • Caravans • Lodges

NEWBRIDGE COUNTRY PARK

Our brand new development is situated just a stones throw from the town of Dumfries. Home of Robert Burns and one of Scotland's oldest bridge's this bustling, quirky market town is the ideal place for your new holiday home. Dubbed as the "queen of the south" this quaint market town certainly lives up to its name...

OWN YOUR OWN LUXURY HOLIDAY HOME FROM JUST £49,995.....

Situated in a stunning countryside location, Newbridge Country Park is the perfect place to relax, unwind and recharge. Own your own piece of the Scottish Riviera from just £49,995... Plus Pre-Order Today and get your first year of site fee's for FREE.



Site Layout

COMPLETION JUNE 2022

RESERVE YOUR PLOT TODAY

LODGES AVAILABLE FOR PRE ORDER:

AvantGarde - 2 bed lodge

AvantGarde VIP - 2 bed luxury lodge with extra added features as standard

Countryside Lodge (40ft x 20ft) - 2 bed, 2 bath, stunning luxurious interior.

**RESERVE
YOUR PLOT
TODAY
& SAVE**

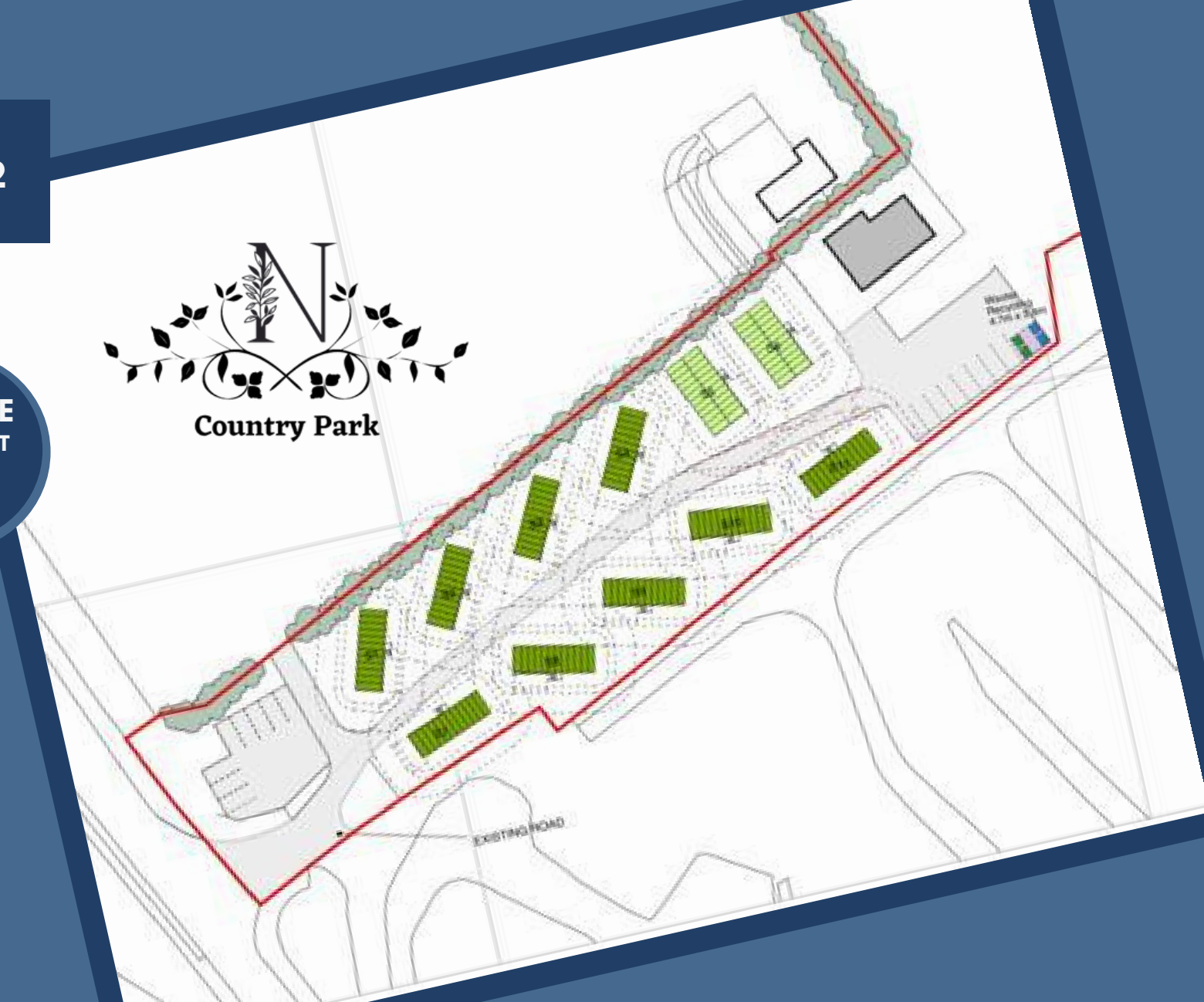

Pre Order Today

**GET YOUR FIRST YEAR OF SITE FEE'S
FOR FREE**



Enquire Today

info@newbridgecountrypark.co.uk

NEWBRIDGE COUNTRY PARK, GLASGOW ROAD , DUMFRIES, DG2 0LF

CURRENT

listings

PROPERTY

Details

The Avantgarde is a very popular model that offers a luxury park home at a very affordable price. As standard this luxury lodge includes patio doors which could give access to your very own decked area (option) and offers great views from your home of the surrounding countryside.

The livingroom is stylish and modern in decor which can also include optional luxury furniture.

A modern kitchen with high gloss doors, under unit lighting and many integrated appliances is included as standard and shaker doors plus other upgrades are available as an option.

The bathroom includes mirrored cabinets and a dual flush toilet.

Lodge features:

- Graphite Georgian Bar Upvc double glazed windows and door/s
- Gas combi central heating system
- Steel pantile roof
- PVC cladding to the exterior
- Lagged pipes
- Exterior lighting
- Feature fire surround with TV point above and twin HDMI
- TV point and HDMI in all bedrooms
- Full gas oven
- Smoked glass cooker hood
- Inbuilt microwave
- Double stand-up fridge freezer
- Domestic interior doors
- Gas ram bed with under bed storage to main bedroom
- Vaulted ceiling throughout
- Thermostatic shower mixer
- Soft touch closing cupboards and drawers
- 2/3 external roof peaks
- Chrome sockets
- Frosted glazed main door
- Carpets and vinyl included
- Beds included
- Soft touch closing kitchen cupboards and drawers
- Built in USB points in kitchen island



AVANTGARDE 2 BED



Take a tour

AVANTGARDE (40FT X 13FT) FLOOR PLAN



CURRENT

listings

PROPERTY

Details

The Avantgarde V.I.P. is a very popular model with a touch of luxury. It is available in both 13ft and 14ft models and includes many extras all built into an affordable price.

It features patio doors to the front giving you direct access to your own deck (option). The living room is wonderfully inviting, with optional luxury furnishing.

The bedrooms, include plush headboards. The modern stylish kitchen has high gloss doors with under unit lighting and many integrated appliances. Shaker doors are also available as option. The Avantgarde V.I.P. has a light and spacious bathroom with a shower above the bath plus a second shower room featuring a large shower enclosure; both include mirrored cabinets and dual flush toilets. If you are looking for a luxury holiday home that has everything the Avantgarde V.I.P. is the home to view.

AVANTGARDE VIP (40FT X 14FT) 3 BED FLOOR PLAN



AVANTGARDE VIP (40FT X 13FT) 2 BED FLOOR PLAN

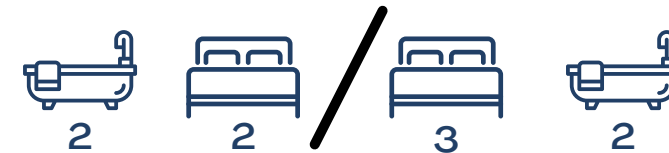

AVANTGARDE VIP



Lodge features:

- Graphite Georgian Bar Upvc double glazed windows and door/s
- Gas combi central heating system
- Steel pantile roof
- PVC cladding to the exterior
- Lagged pipes
- Exterior light
- Feature fire surround with TV point above and twin HDMI
- TV point and HDMI in all bedrooms
- Full gas oven
- Smoked glass cooker hood
- Integrated microwave
- Double stand-up fridge freezer*
- Domestic interior doors
- Gas ram bed with under bed storage to main bedroom
- Vaulted ceiling throughout
- Thermostatic shower mixer
- Soft touch closing kitchen cupboards and drawers
- Decorative plinth and island LED lights
- 3 external roof peaks
- Chrome sockets
- Beds, mattresses, carpets and curtains included
- Built in USB points in kitchen island
- Frosted glazed main door
- Integrated dishwasher
- En-suite bathroom and walk-in wardrobe in master bedroom

CURRENT

listings

PROPERTY

Details



COUNTRYSIDE (40FT X 20FT) 2 BED FLOORPLAN

This residential lodge is designed to give a warm country feeling at a great price. You get all you need in comfort and space from the clever styling. Comfy sofas, separate dining area and well fitted kitchen are all included in the Countryside Lodge along with plenty of storage space including lift up main bed with storage beneath, two shower rooms – one with a bath in the larger lodges, it also has the added advantage of a useful utility room with washer/dryer space, cloak cupboard and door to the exterior.

The open plan living area is spacious and well planned, the large patio doors allowing you access to your outside space easily. Fresh colours have been used to give the unit a light and airy feel to uplift your mood. Well planned and thought through, this unit is a real gem, ideal to start your Lodge experience.



THE COUNTRYSIDE



Take a tour

Lodge features:

The Countryside Lodge comes packed with a whole host of standard features and optional extras.

- Pre galvanised I beam chassis
- Upvc double glazed windows & doors
- Extra insulation
- Lagged pipes
- Gas combi central heating system
- Steel pantile roof
- Domestic guttering & downpipes
- Vaulted ceiling throughout
- Feature patio doors to the front
- Dining table & chairs
- Coffee table
- Oven & grill
- Feature electric fire suite
- Stainless steel cooker hood
- Large integrated fridge freezer
- Integrated dishwasher
- Integrated microwave
- Pop up socket tower in island unit
- Feature lighting
- Lift up storage bed in main bedroom
- Ample storage space
- Feature headboards
- Thermostatic shower
- Separate utility room
- Integrated washer/dryer
- En-suite bathroom and walk-in wardrobe in master bedroom

AVAILABLE
FOR

Pre Order



HOLIDAY HOME

selection



The Chorus

AVAILABLE
FOR
Pre Order

The Chorus offers spacious open plan living area, L-shape lounge seating with pull out bed, fully equipped kitchen, free standing dining table/chairs, comfy bedrooms, practical storage solutions throughout – designed from end to end with your leisure in mind.

The Chorus 5 is a perennial favourite with its open plan living area featuring elegant L-shaped sofa with armrest featuring USB charging socket, light wood wall panels and furniture with stylish grey drawer fronts and modern electric fire.

The adjoining dining area has a free standing light wood table top with black metal legs and coordinating black wood dining chairs. This space is separated from the entrance by a built-in shelving unit.

The fitted kitchen in the Chorus 5 is stunning. Its focal point is the copper coloured glass splash back with stainless steel and glass overhead vented extractor. There is an electric oven with grill, 4 ring gas hob and integrated fridge/freezer included as standard.

The Chorus 5 main bedroom is truly stunning. The graphite built in wardrobes are complemented by matching over-bed storage above the kingsize bed. A dressing table with tub style stool and feature strip lighting to the headboard complete a remarkable sleep space.

The second bedroom also features graphite fitted furniture and twin beds. The Chorus 5 has room to sleep the whole family and store all those ‘essentials’ you need when you take that well deserved break.

The Chorus 5 main bathroom has a large shower cubicle, wash basin with mirrored cabinet above, WC and extractor fan. With the exception of the 28ft model, all Chorus 5 holiday homes have an en-suite wash basin and WC to the main bedroom.

The Chorus 5 comes complete with central heating, double glazing and extra insulation as standard to guarantee you'll enjoy your time away whatever the weather has in store.

- Sizes
- 28ft x 12ft – 2 bedroom/6 berth
 - 32ft x 12ft – 2 bedroom/6 berth
 - 36ft x 12ft – 2 bedroom/6 berth
 - 39ft x 12ft 2 shower – 2 bedroom/6 berth
 - 40ft x 12ft – 3 bedroom/8 berth



Take a tour

Standard features:

- Central heating
- PVC double glazing
- Extra insulation
- Exterior light
- Low energy lighting
- Sockets with USB port
- Integrated electric oven and grill with 4-ring hob and electric ignition
- Cooker extractor vented to exterior
- L-shape lounge seating with footstool
- Free standing dining table and chairs
- En suite WC to master bedroom
- Feature strip lighting to bedrooms
- Extractor fan to main bathroom/shower room
- Integrated fridge freezer
- Pull out bed to lounge
- Appliance shelf and socket

Upgrade options:

- Front french doors
- Fully galvanised chassis
- Pre galvanised chassis
- Ultrawarm insulation
- Upgrade to graphite windows
- Environmental colours
- Environmental colours complete with graphite windows & doors
- Rigid PVC cladding white windows
- Rigid PVC cladding colour windows
- Canexel cladding white windows
- Canexel cladding coloured windows
- Timber cladding oak windows
- Integrated microwave
- Integrated dishwasher
- Integrated washer/dryer
- Integrated washing machine
- Coffee table
- Lounge scatter cushions
- Plinth heaters & heated towel rails
- Lift up double bed (gas strut) base
- Gazunder twin bed
- TV points & co-ax to bedrooms
- Hallway door
- Standard bedding set
- Deluxe bedding set

HOLIDAY HOME

selection



AVAILABLE
FOR
Pre Order

The heritage

The Heritage with its 7ft high ceilings the Heritage interior is a stunner! The open plan living space features 2 and 3 seater sofas with deep button arms. Throughout the use of charming, muted tones and delicate hues are presented across the kitchen/dining area creating an incredibly cool, relaxing environment.

With its 7ft side walls and feature aspect windows, the Heritage 3 has an exceptionally light and airy living space. The freestanding 2 and 3-seater sofas feature luxurious deep button arms and the contemporary fire surround houses a log burner style fire cabinet.

The dining area adjoining the kitchen has a light wood freestanding table with 4 cream wood dining chairs.

The spacious open plan kitchen in the Heritage 3 features stunning willow green cabinets and stone-effect contrast tops. This model has an integrated oven and grill, extractor hood and fridge/freezer and black composite sink and mixer tap as standard.

The Heritage 3 benefits from a large master bedroom with king size bed accompanied by a deep buttoned headboard and freestanding furniture in light wood with willow green fronts. The large dressing table comes complete with a tub style stool and circular mirror above.

Available in 2 and 3 bedroom layouts with each bedroom containing two single beds with the same style furniture and headboards as the main bedroom.

The main bathroom features a large shower cubicle, fitted cabinet with wooden splash-back, counter top basin and WC. All models boast an en-suite comprising wash basin and WC to the main bedroom with selected models featuring a shower in addition.

The Heritage 3 now comes in 7 different layouts with 12ft and 13ft widths and lengths from 36ft to 40ft including the two exciting new twin shower configurations. This is the ideal choice for those wanting a versatile, spacious holiday home.

- Sizes**
- 36ft x 12ft – 2 bedroom/6 berth
 - 38ft x 12ft – 2 bedroom/6 berth
 - 39ft x 13ft 2 shower – 2 bedroom/6 berth
 - 40ft x 12ft – 3 bedroom/8 berth
 - 38ft x 13ft – 2 bedroom/6 berth
 - 39ft x 13ft 2 shower – 2 bedroom/6 berth
 - 40ft x 13ft – 3 bedroom/8 berth



Take a tour

Standard features:

- Matt finish châteaux grey cladding
- Low energy lighting
- Feature aspect windows
- Integrated fridge freezer
- Free standing two and three-seater suite with deep button arms
- Pull out sofa bed to lounge
- Electric fire
- Feature fire cabinet
- Low energy lighting
- Sockets with USB to bedrooms, kitchen and lounge
- Freestanding dining table and chairs
- Re-circulating electric extractor hood
- Integrated electric oven and grill with 4 ring hob with electric ignition
- Over bed reading lights
- Feature fire cabinet
- TV point to master bedroom
- Feature dining pendant light
- Carpet with underlay
- En suite bathroom to all models
- Extractor fan to main bathroom/shower room
- Exterior light

Upgrade options:

- Popular Selected Options
- Winter warm pack
 - Ultrawarm insulation
 - Front french doors
 - Fully galvanised chassis
 - Pre galvanised chassis
 - Upgrade to graphite windows
 - Environmental colours
 - Environmental colours complete with graphite windows & doors
 - Rigid PVC cladding white windows
 - Rigid PVC cladding colour windows
 - Canexel cladding white windows
 - Canexel cladding coloured windows
 - Timber cladding oak windows
 - Integrated microwave
 - Integrated dishwasher*
 - Integrated washer/dryer*
 - Integrated washing machine*
 - Wine cooler (13ft models only)
 - Coffee table
 - Lounge footstool
 - Lounge scatter cushions
 - Wall mounted tv point in lounge
 - Plinth heaters & heated towel rails
 - Lift up double bed (gas strut) base
 - Gazunder twin bed
 - TV point to twin bedroom
 - Standard bedding set
 - Deluxe bedding set

HOLIDAY HOME

selection



Country Park

AVAILABLE

FOR

Pre Order

The Debonair

Standard features:

- Free standing two and three-seater suite complete with stag and bolster cushions
- Free standing table and chairs
- Pull out bed to lounge
- Integrated electric oven and grill with 4-ring gas hob and electric ignition
- Sockets with USB port
- Low energy lighting
- Recirculating electric cooker hood
- Designer interior lighting throughout
- En-suite WC to master bedroom
- Integrated fridge freezer
- Exterior fan to main bathroom/shower room
- Appliance shelf and socket

Upgrade options:

Popular Selected Options

- Winter warm pack
- Ultrawarm insulation
- Front sliding doors
- Fully galvanised chassis
- Pre galvanised chassis
- Upgrade to graphite windows
- Environmental colours
- Environmental colours complete with graphite windows & doors
- Rigid PVC cladding white windows
- Rigid PVC cladding colour windows
- Canexel cladding white windows
- Canexel cladding coloured windows
- Timber cladding oak windows
- Integrated microwave
- Integrated dishwasher
- Integrated washer/dryer
- Integrated washing machine
- Wine cooler in 13ft models
- Coffee table
- Lounge footstool
- Wall mounted TV point in lounge
- Plinth heaters & heated towel rails
- Lift up double bed (gas strut) base
- Gazunder twin bed
- TV points & co-ax to bedrooms
- Standard bedding set
- Deluxe bedding set

The Debonair, a stunning example of how traditional features can successfully blend with the best in modern design. The mix of warm muted colours and carefully toned fabrics create a relaxing country home feel throughout the living, kitchen/dining area, whilst fixtures and fittings deliver the best in style, efficiency and convenience. The Debonair 8 interior is an epitome of country home living. The lounge has freestanding 2 and 3 seater settees with homely fabrics and contrasting stag and bolster cushions. The living room also features a log-burner style electric fire in a traditional mantelpiece setting. The farmhouse style dining table is complemented by matching chairs which continue the country theme. The Debonair 8 has a fully fitted farmhouse-style kitchen benefiting from an integrated oven and 5 ring gas hob, electric cooker hood and integrated fridge freezer. The kitchen units are a mixture of standard and glass fronted doors for an added touch of elegance. The main bedroom continues the traditional styling with beautiful built in furniture and kingsize bed. Light floods in to the bedroom through the large three-quarter height window and the bedroom is completed with en-suite comprising wash basin and WC. The second bedroom features two single beds and a built in wardrobe with over bed storage. There is also a 3 bedroom model available giving extra sleeping options. The main shower room has a large shower cubicle, stylish countertop wash basin with storage cabinet below, WC and external extractor fan. The en-suite to the main bedroom has a wash basin with mirror above and WC.

Due to its great popularity, there are now 7 variations of the Debonair 8 available. The 12ft and 13ft widths come in lengths between 36ft to 40ft including two exciting new twin shower configurations.

Sizes

- 36ft x 12ft – 2 bedroom/6 berth
- 38ft x 12ft – 2 bedroom/6 berth
- 38ft x 12ft – 3 bedroom/8 berth
- 40ft x 12ft 2 shower – 2 bedroom/6 berth
- 38ft x 13ft – 2 bedroom/6 berth
- 40ft x 13ft 2 SHOWERS – 2 bedroom/6 berth
- 40ft x 13ft – 3 bedroom/8 berth



Take a tour

HOLIDAY HOME

selection



Country Park

The Lilac

AVAILABLE
FOR
Pre Order

THE LILAC LODGE OFFERS THE VERY BEST IN CONTEMPORARY AFFORDABLE LUXURY CONTINUING TO HOLD ITS PLACE IN THE COMPETITIVE MARKET WITH ITS HOME FROM HOME FEEL. COMPLETE WITH A SPACIOUS LAYOUT, BEAUTIFUL SOFT FURNISHINGS, AND PRACTICAL STORAGE SOLUTIONS. THIS HOLIDAY HOME REALLY IS PERFECT FOR THE WHOLE FAMILY.

THE LILAC LODGE 11 HAS A LARGE LIVING ROOM WITH TWO LUXURIOUS 2-SEATER SOFAS AND STOVE-STYLE ELECTRIC FIRE HOUSED IN A FULL HEIGHT WOOD-EFFECT FIRE SURROUND. A TV CABINET AND CONTEMPORARY SHELF UNITS PROVIDE AMPLE STORAGE SPACE. THE DINING AREA HAS A FREE-STANDING TABLE AND 6 DINING CHAIRS. A BRISE SOLEIL CREATES MAKES THE LIVING ROOM COSY WHILE STILL LETTING LIGHT FLOOD THOUGH AND THERE IS ALSO AN OFFICE SPACE WITH A DESK AND CHAIR.

THERE IS A FULLY FITTED KITCHEN WITH ELECTRIC OVEN, GRILL, 5 BURNER HOB, EXTRACTOR HOOD AND INTEGRATED FRIDGE FREEZER. THE OPTIONAL LUXURY PACK ADDS INTEGRATED DISHWASHER, MICROWAVE AND WASHING MACHINE TO CREATE THE ULTIMATE LIVING SPACE.

THE MAIN BEDROOM FEATURES A KINGSIZE DIVAN WITH TWO BEDSIDE CABINETS AND A WOOD SLAT DECORATIVE FEATURE WALL WHICH DOUBLES AS AN IMPRESSIVE HEADBOARD. OTHER HIGHLIGHTS ARE THE WALK-IN WARDROBE AND DRESSING TABLE WITH LARGE UPHOLSTERED STOOL.

THE TWIN BEDROOM ALSO INCLUDES WOODEN FEATURE WALLS FOR EACH OF THE LARGE SINGLE BEDS. THERE ARE PLENTY OF STORAGE OPTIONS WITH BUILT IN WARDROBES AND DRAWER UNITS.

THE MASTER BEDROOM EN-SUITE HAS A BATH WITH SHOWER OVER BATH†, WET WALL AND BATH SCREEN, WC AND EXTRACTOR FAN. THE BUILT IN VANITY UNIT HAS A MODERN COUNTERTOP WASH BASIN WITH MIRROR ABOVE.

THE SECOND BATHROOM IN THE LILAC LODGE IS FITTED WITH A WASH BASIN, SHOWER CUBICLE, WC AND EXTRACTOR FAN.

SIZES

- 40FT x 16FT – 2 BEDROOM/4 BERTH
- 40FT x 16FT – 3 BEDROOM/6 BERTH
- 36FT x 20FT – 2 BEDROOM/4 BERTH
- 40FT x 20FT – 2 BEDROOM/4 BERTH
- 40FT x 20FT – 3 BEDROOM/6 BERTH



Take a tour

- Standard features:*
- CENTRAL HEATING AND TOWEL RADIATOR
 - PVC DOUBLE GLAZING
 - EXTRA INSULATION
 - FRONT FRENCH DOORS
 - LOW ENERGY LIGHTING
 - SOCKETS WITH USB PORT
 - EXTERIOR LIGHT
 - BATH IN THE TWO BEDROOM MODELS
 - TV POINTS TO MASTER AND TWIN BEDROOMS COMPLETE WITH SIGNAL BOOSTER
 - ELECTRIC STOVE FIRE
 - WALK IN WARDROBE IN THE TWO BEDROOM MODELS
 - EXTRACTOR FAN TO MAIN SHOWER/BATHROOM AND EN SUITE
 - DIVAN BEDS TO ALL BEDROOMS
 - HIGH LEVEL ELECTRIC OVEN AND GRILL WITH ELECTRIC IGNITION AND 5 BURNER HOB WITH ELECTRIC COOKER EXTRACTOR HOOD
 - FULLY GALVANISED CHASSIS
 - VINYL CLADDING
 - APPLIANCE SHELF AND SOCKET
 - FREE STANDING DINING TABLE AND CHAIRS
 - TV POINT ABOVE FIRE
 - INTEGRATED FRIDGE FREEZER
 - SHOWER OVER BATH WITH WET WALL AND CONCERTINA BATH SCREEN
 - TWO FREESTANDING SOFAS

POPULAR SELECTED OPTIONS

- LUXURY PACK
- ULTRAWARM INSULATION
- BS3632 RESIDENTIAL SPECIFICATION
- DOWNLIGHTERS UNDER FRONT EAVES X 4
- DOWNLIGHTERS UNDER FRONT EAVES X 2
- BAY WINDOW TO LOUNGE (NEARSIDE)*
- UPGRADE TO GRAPHITE WINDOWS
- RIGID PVC CLADDING WHITE WINDOWS
- RIGID PVC CLADDING COLOUR WINDOWS INC ENV
- CANEXEL CLADDING WHITE WINDOWS
- CANEXEL CLADDING COLOURED WINDOWS
- TIMBER CLADDING OAK WINDOWS
- TONGUE & GROOVE PANELLED CEILING
- INTEGRATED MICROWAVE
- INTEGRATED 18 BOTTLE WINE COOLER
- INTEGRATED FULL SIZE WASHER / DRYER
- INTEGRATED FULL SIZE WASHING MACHINE*
- EXTRA DINING CHAIRS (EACH)
- PULL OUT BED TO LOUNGE
- LOUNGE FOOTSTOOL
- 3 SEATER SETTEE IN PLACE OF 2 SEATER
- 2 ARMCHAIRS IN PLACE OF 2 SEATER SETTEE
- STANDARD BEDDING SET
- DELUXE BEDDING SET
- SHOWER CUBICLE IN LIEU OF BATH

Upgrade options:

CONTACT US

for bookings and viewings

info@newbridgecountrypark.co.uk



Enquire Today

NEWBRIDGE COUNTRY PARK,
GLASGOW ROAD
DUMFRIES, DG2 0LF

Order Today

**GET YOUR FIRST YEAR OF SITE FEE'S
FOR FREE**